

Pneumatic Crimping Applicator (Insulator Push-on Crimp)

RSM-ENA-40SI

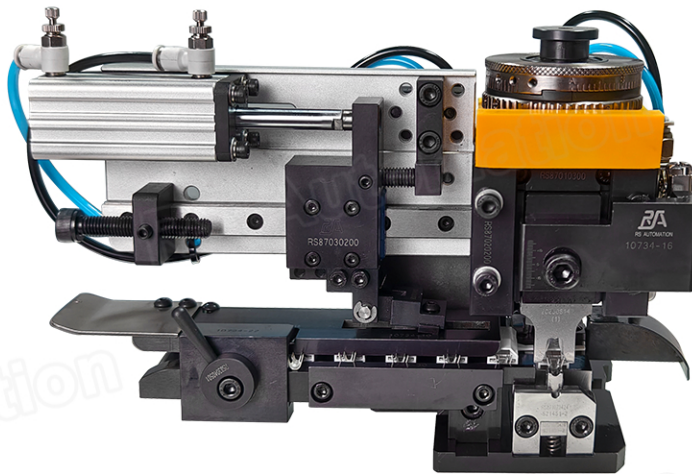

15 DAYs
lead time

Feature

- Especially designed for insulator push-on crimp of insulated products from ETCO, TE, AMP and other brands. (See terminal model list below)

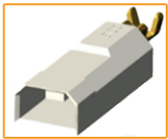

- Continuous crimping height adjustment provides a 0.02mm resolution for C.H./I.H. with a 2.0mm range, which meet every rigorous demand on the crimping.
- Modular framework to make adjustment and maintenance easier.
- Terminal pitch 45mm become true easily and feeding speed can be adjusted with facility.
- Save repeated invest. It can work for semi-automatic and fully automatic crimping machine for Komax, AMP, Mecal and so on;
- Each applicator delivered will be attached with a terminal cross section analysis report.
- Lower maintenance cost. Special surface treatment to ensure strong corrosion resistance.
- Each spare part has its own P/N number for easier maintenance.

Specification

Model	RSM-ENA-40SI
Feed Type	Side Feed
Stroke	40mm
Shut Height	135.8mm
Wire Size	3mm ² -15mm ²
Terminal Thickness	2mm (Max)
Feeding System	Pneumatic
Terminal Pitch	45mm (Max)
Weight	5.4kg
Dimension	L215mm*W104mm*H165mm